

## 50 The Dale, Abergele, LL22 7DS

£200,000

2 1 1



Welcoming new to the market this charming, ready to walk into, semi-detached bungalow with no onward chain! Comprising of two bedrooms, spacious lounge/dining area, bright kitchen and modernized three piece bathroom suite. Benefiting from having a concrete driveway perfect for off-street parking, detached garage providing power and light with a south facing, low maintenance garden to the rear offering stunning woodland views. Located within walking distance to Abergele Golf Course and to the town centre offering a variety of cafes, shops and Tesco Supermarket.

## Key Features

- Semi - detached bungalow
- Two bedrooms
- South facing garden
- Within walking distance to the town centre
- EPC - D
- No onward chain
- Detached garage
- Driveway perfect for off-street parking
- Close to the Abergele golf club
- Council Tax Band - C

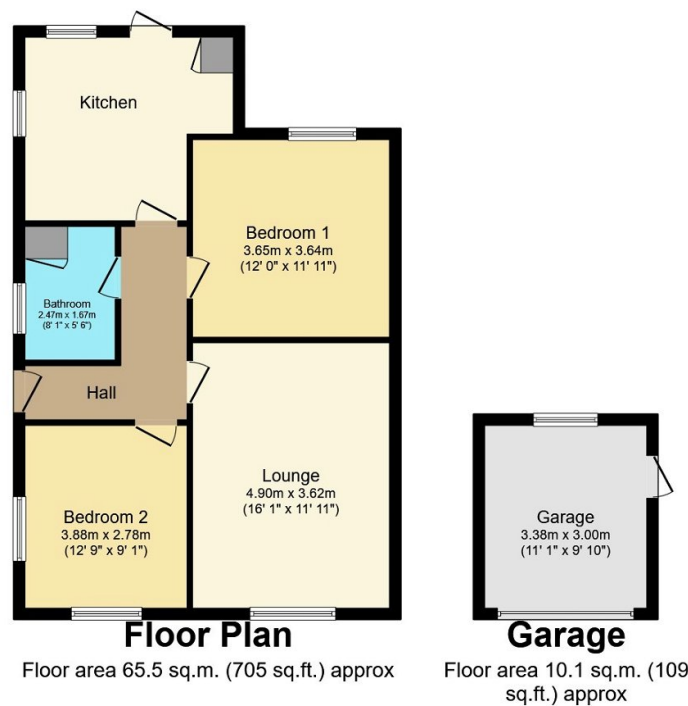

Total floor area 75.7 sq.m. (814 sq.ft.) approx

This plan is for illustration purposes only and may not be representative of the property. Plan not to scale.